

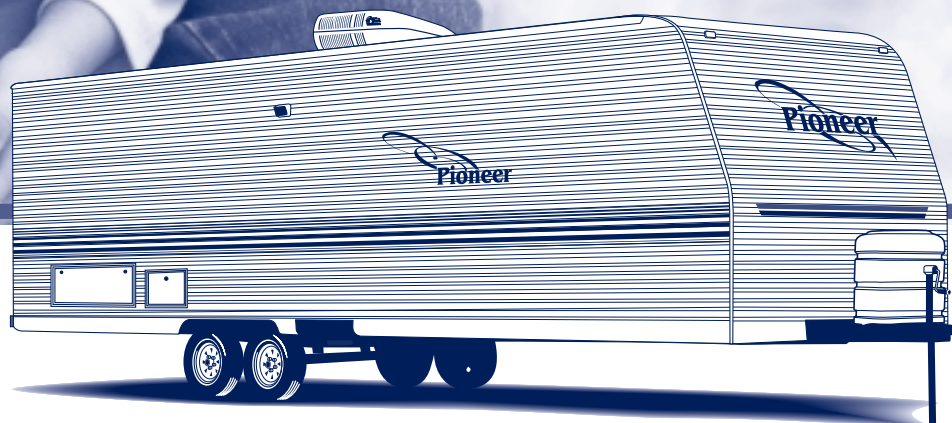

Exploring life with the  
spirit of a pioneer.

---

There are plenty of pioneers  
just like you out there,  
who are itching to hit the road to  
some of nature's finest wonders.  
So break out the maps and start  
carving out your travel plans today.  
One taste of the Pioneer lifestyle  
and you may never want to go  
back home again.



**FLEETWOOD RV**

# Weights & Measurements

MODEL SPECIFICATIONS	18T6	19T4	23T6	24T6	24TB6	25TS6	27T8	27TB8	28TS6	28TRS6	30TS8	30TSB8	30TB10
<b>GVWR</b> (Gross Vehicle Weight Rating) (lbs.) <sup>1</sup>	6,000	6,100	6,600	6,800	6,800	7,700	7,200	7,200	8,200	8,550	8,400	8,400	7,400
<b>GROSS DRY WEIGHT</b> (lbs.) <sup>2,6</sup>	3,905	3,811	4,376	4,447	4,447	5,368	4,836	4,836	5,802	6,395	6,005	6,005	5,377
<b>MAXIMUM CARRYING CAPACITY</b> (lbs.) <sup>3,6</sup>	2,095	2,289	2,224	2,353	2,353	2,332	2,364	2,364	2,398	2,155	2,395	2,395	2,023
<b>HITCH DRY WEIGHT</b> (lbs.) <sup>2,6</sup>	426	484	528	498	498	713	672	672	694	877	895	895	642
<b>LENGTH</b> (' and ") <sup>4,6,8</sup>	23' 1"	23' 11"	27' 11"	28' 8"	28' 8"	30' 1"	31' 6"	31' 6"	33' 2"	32' 6"	34' 8"	34' 8"	35' 2"
<b>WIDTH</b> <sup>6</sup>	8'	8'	8'	8'	8'	8'	8'	8'	8'	8'	8'	8'	8'
<b>TIRE SIZE</b>	14" (C)	14" (C)	14" (C)	14" (C)	14" (C)	15" (C)	14" (C)	14" (C)	15" (C)	15" (C)	15" (C)	15" (C)	14" (C)
<b>HEIGHT</b> (' and ") <sup>5,6</sup>	9' 1"	9' 1"	9' 1"	9' 1"	9' 1"	9' 1"	9' 1"	9' 1"	9' 1"	9' 1"	9' 1"	9' 1"	9' 1"
<b>FRESH WATER HOLDING TANK</b> (Gal.) <sup>6,7</sup>	50	50	50	50	50	50	50	50	50	50	50	50	50
<b>GRAY WATER HOLDING TANK</b> (Gal.) <sup>6,7</sup>	40	40	40	40	40	40	40	40	40	40	40	40	40
<b>BLACK WATER HOLDING TANK</b> (Gal.) <sup>6,7</sup>	40	40	40	40	40	40	40	40	40	40	40	40	40
<b>LPG CAPACITY</b> (lbs.) <sup>6,7</sup>	60	60	60	60	60	60	60	60	60	60	60	60	60

1. (Gross Vehicle Weight Rating) is the maximum permissible weight of this trailer when fully loaded. It includes all weight at the trailer axle(s) and tongue or pin.
2. All dry weights are based on the standard model and do not include optional features or equipment.
3. Maximum Carrying Capacity is determined by subtracting Gross Dry Weight from GVWR. Maximum Carrying Capacity includes all fluids, optional features, equipment, and personal cargo.
4. Trailer length includes 3' 6" for hitch.

5. Add 7" if equipped with optional roof air conditioner.
6. Approximate.
7. Water weight equals 8.3 lbs. per gallon. LPG weight equals 4.5 lbs. per gallon.
8. Add 10" if equipped with optional spare tire and carrier.

**IMPORTANT - PLEASE READ:** Product information, photography and illustrations included in this publication were as accurate as possible at the time of printing. For further product information and changes, please visit our website at [www.fleetwoodrv.com](http://www.fleetwoodrv.com) or contact your local Fleetwood dealer. Prices, materials, design and specifications are subject to change without notice. All weights, fuel, liquid capacities and dimensions are approximate. Fleetwood has designed its recreational vehicles to provide a variety of uses for its customers. Each vehicle features optimal seating, sleeping, storage and fluid capacities. The user is responsible for selecting the proper combination of loads (i.e. occupants, equipment, fluids, cargo, etc.) to ensure that the vehicle's capacities are not exceeded.

## Standard & Optional Features

### CHASSIS

- Main Rail - 6" I-Beam (18T6, 19T4, 23T6, 24T6, 24TB6, 27T8, 27TB8, 30TB10)
- Main Rail - 8" I-Beam (25TS6, 28TS6, 28TRS6, 30TS8, 30TSB8)
- Welded Bumper
- U-Carriage Straight Axles
- Stabilizer Jacks (25TS6, 28TS6, 30TS8, 28TRS6, 30TSB8)
- Entry Double Step (18T6, 19T4, 23T6, 24T6, 24TB6, 27T8, 27TB8, 30TB10)
- Entry Triple Step (25TS6, 28TS6, 28TRS6, 30TS8, 30TSB8)

### EXTERIOR

- (R7) Fiberglass Insulation
- One-Piece Rubber Roof
- High Gloss Aluminum Finish
- 12' Awning (18T6)
- 16' Awning (19T4, 24T6, 24TB6, 30TS8, 30TSB8)
- 19' Awning (23T6, 25TS6, 27T8, 27TB8, 28TS6, 28TRS6, 30TB10)
- Locking Luggage Doors
- Power Cord Storage Hatch
- Non-Locking Potable Water Fill with City Water Inlet
- Wheelwell Skirt
- Entry Assist - White (Each Door)
- Slide-Out Room - Rack & Gear with Flush Floor Slide (25TS6, 28TS6, 28TRS6, 30TS8, 30TSB8)
- Vent - Power Roof (Bath)
- Vents - (Quantity - 2, all models except 18T6) (Quantity -1 for 18T6)
- 30" Entry Door (Pebble Finish)

### WINDOWS (RADIUS)

- White Frame - Clamp Ring (Clear Glass)
- Slider Windows
- Egress Windows
- Mini Blinds & Window Treatment

### APPLIANCES/EQUIPMENT

- Dometic® Refrigerator - Double Door
- Magic Chef® Range, 3-Burner High Output 16", White Top, Black Door
- Rangehood - White 12V, W/ Light
- Microwave
- 25BTU hydroflame® Furnace with Thermostat
- Atwood® Water Heater - DSI LP(6 Gal.)
- TV Antenna with Park Reception
- Monitor Panel - Wallmount
- Fire Extinguisher
- Smoke Detector - Alarm
- LP Gas Leak Detector - Alarm

### ELECTRICAL/120V/12V

- 30 AMP Electrical Service
- 120V GFI Circuit - Bath, Patio, Galley
- Slide-Out Ceiling Light (25TS6, 28TS6, 28TRS6, 30TS8, 30TSB8)
- Pre-Wired For Air Conditioner
- Magnatech® Distribution Panel
- 120V/12V, Battery Charger
- 35 AMP Solid State Converter
- Interior Light - Wall Switched (Bath, Bedroom, Living Area)
- Double 12V Lights - Base Switched
- Pre-Wired For Stereo & Speaker
- Exterior Amber Patio Light - 12V

### GALLEY

- Sink - 19" x 33" Side By Side with Sink Covers (2 Covers Per Model)
- Faucet - Double Handle
- Mini Blind - White
- Galley Edging (T-Molding 1")
- Refrigerator Insert - Pre Finish
- Trash Bag Holder
- Knife Rack
- Pantry with Removable Shelves (24T6, 24TB6, 25TS6, 28TS6, 30TS8, 30TSB8, 30TB10)

### BATH

- Bath Door - White
- Sink - White, Rectangular
- Faucet - Ledge Mount, White
- Marine® Toilet
- Duo Form® Tub - 36" x 23 3/4"
- One-Piece Tub Surround
- Tub Enclosure
- Medicine Cabinet with Mirror
- Brass Towel Bar, Towel Ring, Toilet Paper Holder

### LIVING AREA

- 40" x 72" Jackknife Sofa Bed (Most Models)
- End Panel Curtains
- TV Cabinet
- Free Standing Chairs (28TRS6)

### DINETTES

- 40" x 76" Dinette with Straight Backs
- Pots & Pans Drawer
- Exterior Access Cabinet Door
- Dinette Table
- TV Shelf - Overhead (18T6, 19T4, 23T6, 24T6, 24TB6, 27T8, 27TB8, 30TB10)

### BEDROOM

- Lift-Up Bed Platform with Gas Struts
- Bunk Beds - Foam Mattress 30" x 76 1/2" (24TB6, 27TB8, 30TSB8, 30TB10)
- Double Bed - Innerspring 53" x 74 1/2" (18T6, 24T6, 27T8, 30TS8)
- Queen Bed - Innerspring 60" x 74 1/2" with Fitted Bedspread (Most Models)
- Headboard (Most Models)
- End Panel Curtains
- Folding Door - Primary Sleeping Area
- Divider Curtain - Secondary Sleeping Area (18T6, 24T6, 24TB6, 27T8, 27TB8, 30TSB8, 30TB10)
- Dresser Drawer & Hamper (Most Models)

### INTERIOR CONSTRUCTION

- In-Floor Furnace Ducting
- In-Ceiling A/C Ducting
- Raised Panel Cabinet Doors
- Vinyl Flooring
- Carpet with Foam Pad - Slide-Out Area

### OPTIONS

- Fantastic Vent (Most Models)
- Exterior Shower
- Stereo - AM/FM/CD 12V with 2 Speakers
- Range Cover
- A/C - 13.5M BTU
- LPG Tank Cover
- Carpet (Bedroom, Living Area)
- Scissor Stab Jack - 2 Pair (18T6, 19T4, 23T6, 24T6, 24TB6, 27T8, 27TB8, 30TB10)
- Fixed Spare Tire with Carrier & Cover
- Wall Border
- Free-Standing Chair (All Slide-Out Models)
- Double Bed with Bunk (18T6, 24T6, 27T8, 30TS8)

Floor Plans

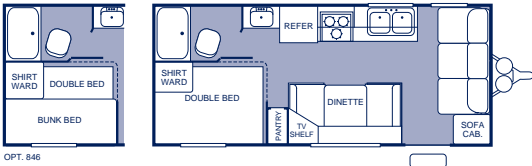

18T6

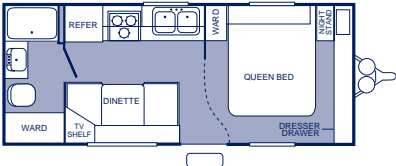

19T4



23T6

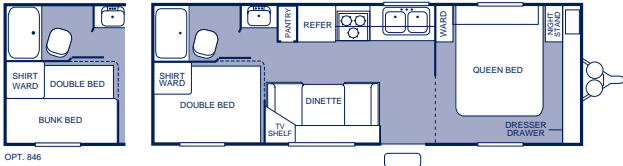

24T6

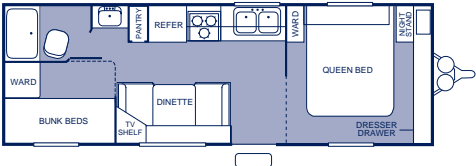

24TB6

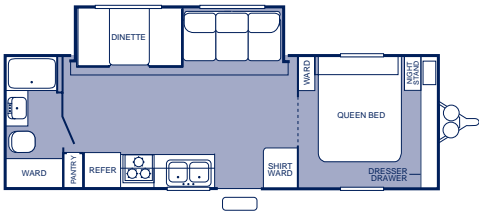

25TS6

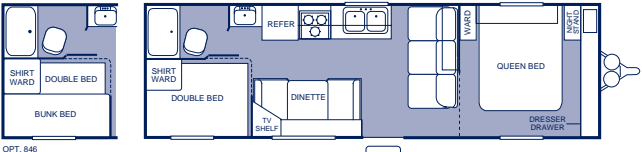

27T8

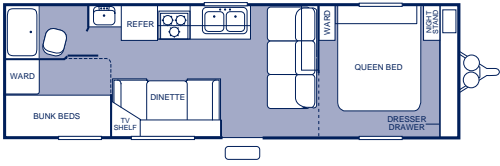

27TB8

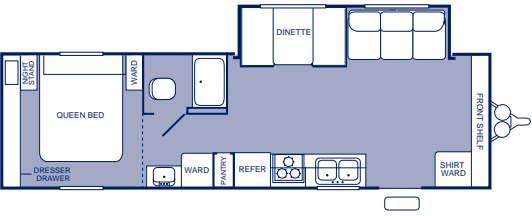

28TS6

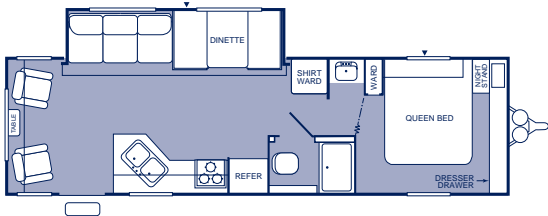

28TRS6

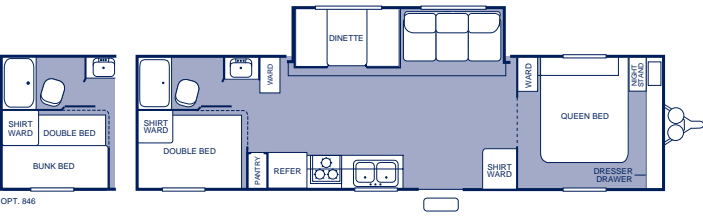

30TS8

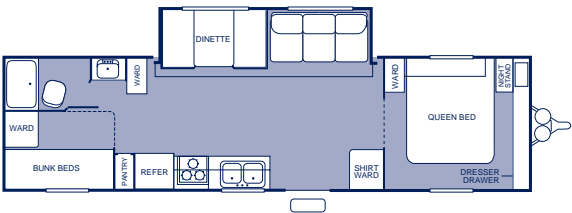

30TSB8



30TB10

## Top Features



### Large Holding Tanks:

- Fresh Water 50 gal.\*
- Grey Water 40 gal.\*
- Black Water 40 gal.\*

### Enclosed Heated Fresh Water Tank

### Baked-On Enamel Color Band

### 30" Main Entry Door

### In-Floor Furnace Ducting

### In-Ceiling Air Conditioner Ducting

### Computer Engineered Chassis

### Trash Bag Holder

### Clothes Hamper (Most Models)

### Bedroom Dresser with 6 Drawers and Roller Guides (Most Models)

### Flush Floor Slide-Out

### One Piece Tub Surround

### Tub Enclosure

### Wooden Medicine Cabinet

### Drop Down Access Door Below Sofa (Most Models)

### 10" of Working Space

### Between Stove and Sink

### Knife Rack

### Sink Lid and Cutting Board

### Pots and Pans Drawer with Roller Guides

### Pantry with Adjustable Shelves (Most Models)

### DSI 6 Gallon Water Heater\*

\*Approximate gallons

## RV OWNERCARE

### THE FLEETWOOD RV TWO-YEAR HITCH TO BUMPER WARRANTY COVERAGE\*

This comprehensive program includes systems, appliances, components and construction—with no additional costs to you.

### TWO-YEAR FULL WARRANTY\*

Leaving the Fleetwood RV dealership after you've purchased your RV doesn't mean leaving Fleetwood's commitment to your satisfaction behind. This complete warranty is unique because it's just that—complete. Some competitive brands only support a one-year warranty and most are limited. Be sure to check.

### FULLY TRANSFERABLE\*

Because we don't hesitate to stand behind our products, the complete **warranty is fully transferable** during the 24-months of warranty coverage, which is a plus for resale value.

### NATIONAL COVERAGE

Traveling to Spokane? Buffalo? We've got you covered with one of the nation's largest trained service networks. In fact, **1,100 Fleetwood dealers** are just a phone call away.

### 24-HOUR ROADSIDE ASSISTANCE PROGRAM

Flat tire? Locked out? First-year roadside service in the U.S. or Canada is **free**. Just sign up with your dealer. After a year, you can continue this service for a reasonable cost.

**Require these features when you purchase your new RV... Fleetwood does!**

### Your local Pioneer dealer is:



**www.fleetwoodrv.com**

Visit our website to find a dealer near you or learn more about other Fleetwood products. Or call us toll-free at 1-800-444-4905.



## TO OUR CUSTOMER FRIENDS...

To make sure that you get the maximum satisfaction out of your recreational vehicle purchase, there are several things you should know:

1. Learn all you can about the travel trailer or fifth wheel you're planning to buy. Don't rely on word of mouth. Get the facts about the actual trailer length, width, unloaded weight with options, Gross Vehicle Weight Rating, and cargo carrying capacity. These are usually available in the manufacturer's sales literature or from the Cargo Carrying Capacity Label located in each trailer. Be sure to check this information **before** you decide which unit to buy.
2. Verify the towing capacity of your tow vehicle. If you don't know, or aren't sure, you can ask at your automotive dealership. Be sure to match its tow rating to the loaded (not dry) weight of your trailer. Include the weight of water, additional accessories, clothing, food, and gear. To help Fleetwood travel trailer customers estimate this total weight, our Gross Vehicle Weight Ratings reflect the maximum weight of the trailer when fully loaded for camping.

Taking these simple steps before you buy will help insure that your trailer and tow vehicle combination is just what you wanted.

Happy Camping!



Interested in meeting new friends that share a similar passion for the great outdoors, having fun & getting discounts on camping related products? Join Club Fleetwood today! The only owners club dedicated to all Fleetwood RV owners. For more information and to join, call 877-577-2560.

**IMPORTANT—PLEASE READ:** Product information, photography and illustrations included in this publication were as accurate as possible at the time of printing. For further product information and changes, please visit our website at [www.fleetwoodrv.com](http://www.fleetwoodrv.com) or contact your local Fleetwood dealer. Prices, materials, design and specifications are subject to change without notice. All weights, fuel, liquid capacities and dimensions are approximate. Fleetwood has designed its recreational vehicles to provide a variety of uses for its customers. Each vehicle features optimal seating, sleeping, storage and fluid capacities. The user is responsible for selecting the proper combination of loads (i.e. occupants, equipment, fluids, cargo, etc.) to ensure that the vehicle's capacities are not exceeded.

\*For complete details, see your Fleetwood RV dealer.

**FLEETWOOD RV**  
The World's #1 RV Manufacturer

Fleetwood Enterprises, Inc. • P.O. Box 7638 • Riverside, CA 92513-7638