

# SUPER LITE SUPER TOWABLE

# **EAGLE**

*Super Lite*

2012



EAGLE SUPER LITE® | TRAVEL TRAILERS AND FIFTH WHEELS BY JAYCO®

AMERICA'S MOST **LIVEABLE** RVs.





EAGLE SUPER LITE FW 31.5RLTS | BROWNSTONE



## AMERICA'S MOST LIVEABLE RVs

Liveability means making your camping experience more comfortable, in an RV you can depend on, at a price you'll feel good about. It's spending quality time together, without spending a fortune. And it's what makes Jayco America's Most Liveable RVs.



# MORE ROOM. MORE HEIGHT. MORE WATER. STILL TOWABLE.

For 2012, we're packing some heavy-hitting upgrades into our lightweight legends. New arched interior ceiling rafters give our Eagle Super Lite travel trailers an 84-inch ceiling height. Meanwhile, our travel trailers and fifth wheels boast a new front cap design. On the fifth wheel, it increases the bedroom space to accommodate 80-inch beds, residential-style nightstands (n/a bed slide models) and roomy wardrobes. Plus, for the family on the go, we offer at least 76 gallons of fresh water capacity. Big on amenities, easy on weight, Eagle Super Lite delivers more.

## EAGLE SUPER LITE TRAVEL TRAILER

With multiple slideouts, spacious living areas, a private bedroom and bunk rooms (select models), you get all the perks of home in an easily towable package.

SLEEPING CAPACITY	UP TO 10
EXTERIOR LENGTH	29' 10"– 35' 7"
UNLOADED WEIGHT	6,560–7,785
FLOORPLANS	10

## EAGLE SUPER LITE HT FW

Designed for today's smaller trucks, the Eagle Super Lite HT is lighter than comparable fifth wheels, while boasting convenient features, like a 26" LCD HDTV and full-body gray fiberglass exterior.

SLEEPING CAPACITY	UP TO 8
EXTERIOR LENGTH	25' 8"– 31' 5"
UNLOADED WEIGHT	5,875–6,830
FLOORPLANS	4

## EAGLE SUPER LITE FIFTH WHEEL

The Eagle Super Lite fifth wheel features raised-panel cabinetry, expansive pass-through storage, name-brand appliances and a modern kitchen—all in a lightweight package.

SLEEPING CAPACITY	UP TO 10
EXTERIOR LENGTH	30' 9"– 34' 2"
UNLOADED WEIGHT	7,800–9,280
FLOORPLANS	8



EAGLE SUPER LITE

SUPER LITE  
SUPER TOWABLE





EAGLE SUPER LITE TT 314BDS | AMBER



EAGLE SUPER LITE TT 314BDS



EAGLE SUPER LITE TT 314BDS | AMBER



EAGLE SUPER LITE TT 314BDS | AMBER

EAGLE SUPER LITE | TRAVEL TRAILERS



# ROOM TO LIVE

Not only is the Eagle Super Lite travel trailer considerably lighter than the competition, it also comes with more standard features and amenities, including a 32" LCD HDTV, J-Steel convertible sofa, magnet-friendly refrigerator and residential-style furniture. In fact, the living areas are so well-appointed, you'll forget you're camping.

## FLOORPLANS

**S** OUTSIDE STORAGE  
**H** TRAILER HITCH  
**LAV** BATHROOM SINK

**MICRO** MICROWAVE  
**OHC** OVERHEAD CABINETS  
**FRIDGE** REFRIGERATOR  
**WARD** WARDROBE

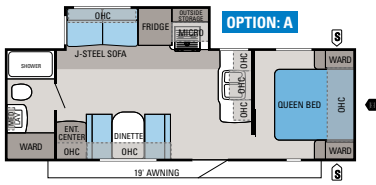

## SUPER LITE TRAVEL TRAILER | 257RBS

Ext. Length: **TBD** Ext. Height: **TBD** Unloaded Wt. (lbs.): **TBD** Sleeps: **4-6**

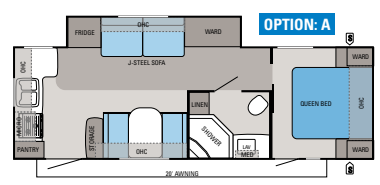

## SUPER LITE TRAVEL TRAILER | 266RKS

Ext. Length: **29' 10"** Ext. Height: **138"** Unloaded Wt. (lbs.): **6,560** Sleeps: **4-6**

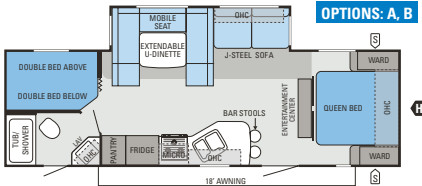

## SUPER LITE TRAVEL TRAILER | 284BHS

Ext. Length: **TBD** Ext. Height: **TBD** Unloaded Wt. (lbs.): **TBD** Sleeps: **6-9**

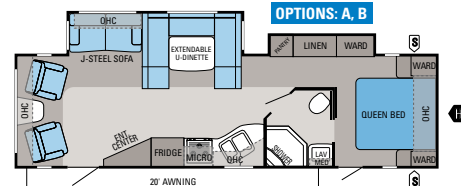

## SUPER LITE TRAVEL TRAILER | 298RLDS

Ext. Length: **34'** Ext. Height: **138"** Unloaded Wt. (lbs.): **7,430** Sleeps: **3-6**

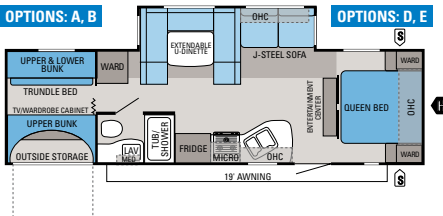

## SUPER LITE TRAVEL TRAILER | 304BHS

Ext. Length: **33' 5"** Ext. Height: **138"** Unloaded Wt. (lbs.): **7,785** Sleeps: **5-10**

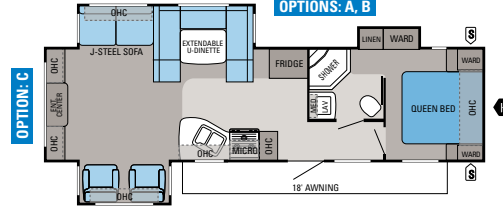

## SUPER LITE TRAVEL TRAILER | 308RETS

Ext. Length: **TBD** Ext. Height: **TBD** Unloaded Wt. (lbs.): **TBD** Sleeps: **3-8**

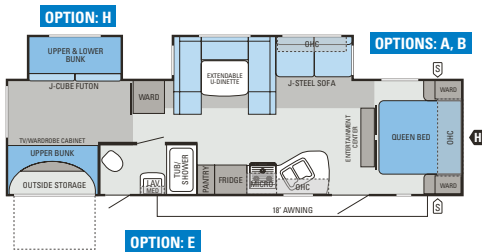

## SUPER LITE TRAVEL TRAILER | 314BDS

Ext. Length: **35' 7"** Ext. Height: **138"** Unloaded Wt. (lbs.): **7,785** Sleeps: **7-10**

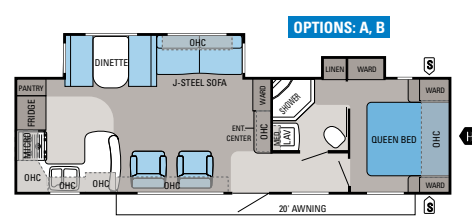

## SUPER LITE TRAVEL TRAILER | 316RKDS

Ext. Length: **TBD** Ext. Height: **TBD** Unloaded Wt. (lbs.): **TBD** Sleeps: **3-6**

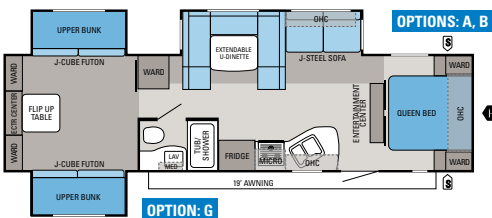

## SUPER LITE TRAVEL TRAILER | 324BTS

Ext. Length: **TBD** Ext. Height: **TBD** Unloaded Wt. (lbs.): **TBD** Sleeps: **9-12**

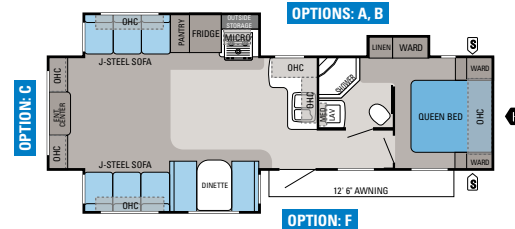

## SUPER LITE TRAVEL TRAILER | 328RLTS

Ext. Length: **TBD** Ext. Height: **TBD** Unloaded Wt. (lbs.): **TBD** Sleeps: **3-8**

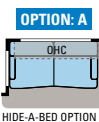

HIDE-A-BED OPTION

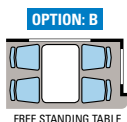

FREE STANDING TABLE &amp; CHAIR OPTION

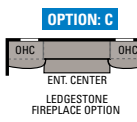

LEDGESTONE FIREPLACE OPTION

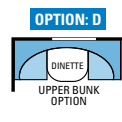

UPPER BUNK OPTION

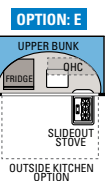

SLIDEOUT KITCHEN OPTION

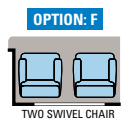

TWO SWIVEL CHAIR OPTION

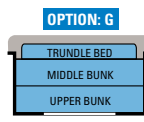

BUNKS WITH TRUNDLE BED OPTION

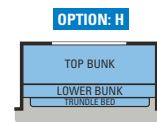

TRUNDLE BED OPTION





EAGLE SUPER LITE FW 31.5RLTS | BROWNSTONE



EAGLE SUPER LITE FW 30.5BHLT | BROWNSTONE



EAGLE SUPER LITE HT FW



EAGLE SUPER LITE FW 31.5RLTS | BROWNSTONE

EAGLE SUPER LITE | FIFTH WHEELS



EAGLE SUPER LITE  
HT FIFTH WHEEL

EAGLE SUPER LITE  
FIFTH WHEEL

# TOTAL PACKAGE

The Eagle Super Lite fifth wheels feature everything you love about its larger counterpart, but in a much lighter package. Whether you choose the HT or our economical Super Lite, you'll find you won't have to sacrifice space or amenities for towability.

## OPTIONS

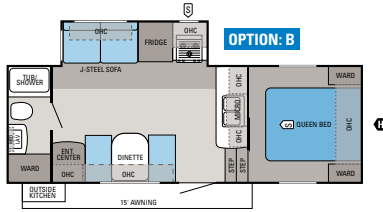
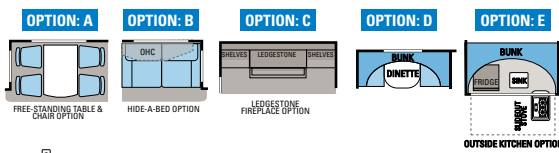

### SUPER LITE HT FIFTH WHEEL | 23.5RBS

Ext. Length: **25' 8"** Ext. Height: **144"** Unloaded Wt. (lbs.): **5,875** Sleeps: **4-6**

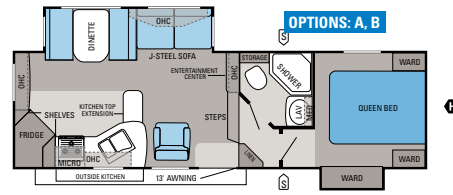

### SUPER LITE HT FIFTH WHEEL | 26.5RKS

Ext. Length: **29' 11"** Ext. Height: **145"** Unloaded Wt. (lbs.): **6,705** Sleeps: **6**

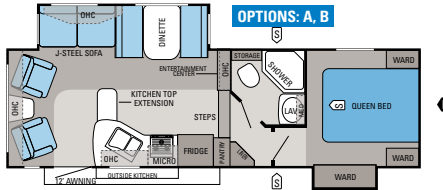

### SUPER LITE HT FIFTH WHEEL | 26.5RLS

Ext. Length: **29' 7"** Ext. Height: **147"** Unloaded Wt. (lbs.): **6,695** Sleeps: **5**

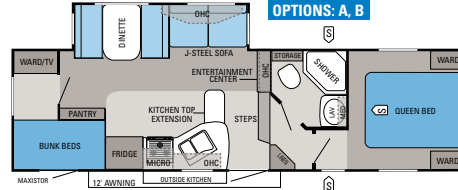

### SUPER LITE HT FIFTH WHEEL | 27.5BHS

Ext. Length: **31' 5"** Ext. Height: **145"** Unloaded Wt. (lbs.): **6,830** Sleeps: **8**

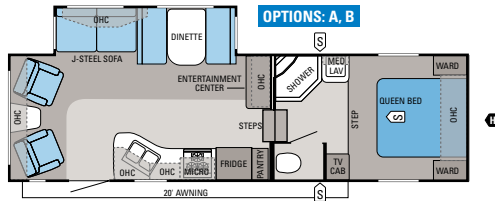

### SUPER LITE FIFTH WHEEL | 28.5RLS

Ext. Length: **30' 9"** Ext. Height: **151"** Unloaded Wt. (lbs.): **7,650** Sleeps: **6**

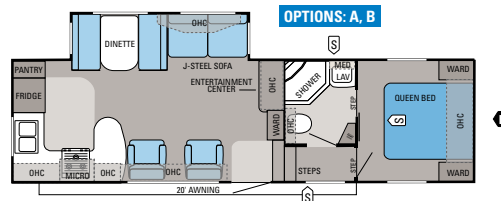

### SUPER LITE FIFTH WHEEL | 29.5RKS

Ext. Length: **31' 9"** Ext. Height: **150"** Unloaded Wt. (lbs.): **7,865** Sleeps: **6**

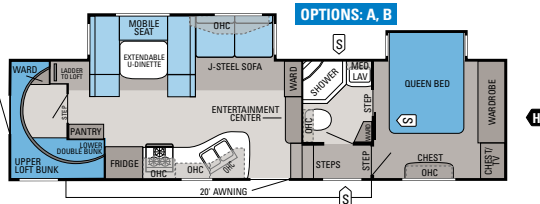

### SUPER LITE FIFTH WHEEL | 30.5BHLT

Ext. Length: **34' 9"** Ext. Height: **153"** Unloaded Wt. (lbs.): **9,135** Sleeps: **9**

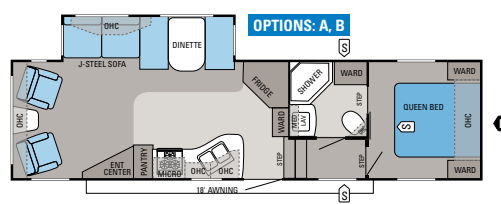

### SUPER LITE FIFTH WHEEL | 30.5RLS

Ext. Length: **33' 2"** Ext. Height: **152"** Unloaded Wt. (lbs.): **8,170** Sleeps: **6**

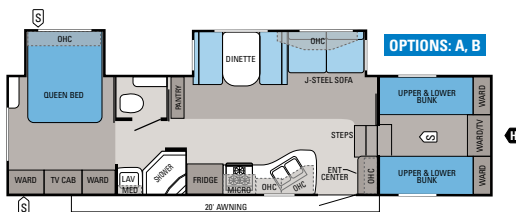

### SUPER LITE FIFTH WHEEL | 31.5FBHS

Ext. Length: **34' 1"** Ext. Height: **152"** Unloaded Wt. (lbs.): **8,445** Sleeps: **10**

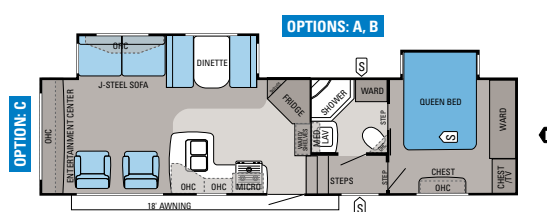

### SUPER LITE FIFTH WHEEL | 31.5RLDS

Ext. Length: **34' 2"** Ext. Height: **156"** Unloaded Wt. (lbs.): **8,725** Sleeps: **6**

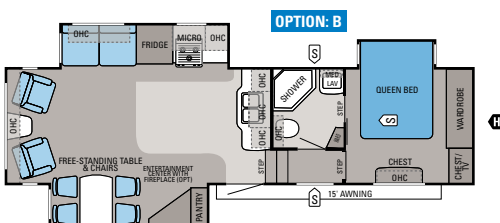

### SUPER LITE FIFTH WHEEL | 31.5RLTS

Ext. Length: **33' 10"** Ext. Height: **157"** Unloaded Wt. (lbs.): **9,130** Sleeps: **4**

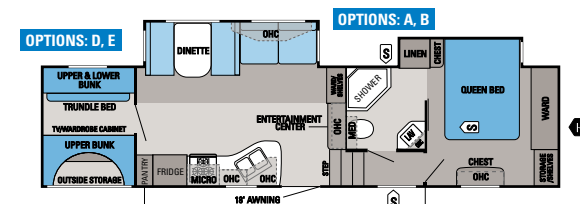

### SUPER LITE FIFTH WHEEL | 33.5QBDS

Ext. Length: **TBD** Ext. Height: **TBD** Unloaded Wt. (lbs.): **TBD** Sleeps: **5-10**

## EAGLE SUPER LITE STANDARDS AND OPTIONS

### STANDARD INTERIOR EQUIPMENT

6 cu. ft. Norcold refrigerator
26" LCD HDTV (select models)
32" LCD HDTV (select models)
76-plus gallons of fresh water capacity (select models)
80" beds (select models)
312-coil innerspring mattress
A/C Chillgrille
Arched interior ceiling rafters for 84" headroom (select models)
Ball bearing drawer guides, 50-lb. capacity with full-drawer extension
Cable and satellite TV prepped
Crank-up HDTV antenna with signal booster
Diamondfloor vinyl flooring
Deep storage drawers under booth dinette, accessible by doors/drawers
Dream Dinette table mechanism (select models)
Fully accessible storage under main bed
Glass shower door
Magnet-friendly refrigerator front
Oversized 21" oven (select models)
Pleated night shades
Porcelain toilet with foot flush
Pre-drilled and screwed cabinet construction
Raised-panel cabinet doors throughout
Reflective (R-15) foil insulation in slideout floors under carpet
Residential soft goods designed and made by Jayco
Residential-sized kitchen sink with dual covers
Swivel rocker(s) (select models)

### STANDARD EXTERIOR EQUIPMENT

30-amp power cord (select models)
30" x 72" radius-cornered main entry door
50-amp power cord (select models)
Aerodynamic front cap
Big Easy entrance step with 10" deep treads
Battery disconnect (select models)
Black tank sprayer
E-Z Lube axles
Foldable, exterior grab handle
Frame prepped for bike rack/cargo tray (select models)
Heated and enclosed fresh water tank and holding tanks
High-output marine grade exterior speakers (2)
I-Class cambered structural steel
I-beam frame
LTI slideout seals
MOR/ryde CRE 3000 axle equalizer (select models)
Outdoor media center (select models)
Prep for outside grill
Radial tires
Rain guttering, molded with extended drip spouts
Reflective foil insulation in slideout floors and roof (R-15) (select models)
Safety step light
Seamless one-piece rubber roof
Security light, door side
Spare tire with carrier (select models)
Stabilizer jacks
Tinted safety-glass windows
TuffShell vacuum-bonded laminated sidewalls, slideouts and back wall
Water system winterization kit

### OPTIONS

2nd A/C (select models)
8 cu. ft. Norcold refrigerator (n/a with Deluxe Package)
Aluminum rims (select models)
Bedroom carpet (select models)
Bike rack/cargo tray system (select models)
Customer Value Package
Customer Value Package with 15,000-BTU A/C
Deluxe Package (select models)
Electric stabilizer jacks
Electric tongue jack (select models)
Fireplace (select models)
Free-standing table with 4 chairs (select models)
Glacier Package (extra layer of R-7 insulation in roof, R-15 foil in main floor)
Hide-a-bed in lieu of 2 chairs (select models)
Hide-a-bed with air mattress
Keyless entry (select models)
Ledgestone fireplace (select models)
Linoleum in living area (select models)
MOR/ryde pin box (select models)
Outside kitchen (select models)
Portable, outside gas grill
Reese Revolution pin box (select models)
Roof ladder
Satellite kit
Solid-surface kitchen countertops (select models)
Spare tire with carrier (HT)
Thermal pane tinted safety-glass windows
Trundle bed (select models)
Water purification system

### CUSTOMER VALUE PACKAGE (MANDATORY)

6-gal. gas/electric DSI auto-ignition water heater (select models)
30-lb. propane gas bottles
13,500-BTU A/C with wall thermostat with louvered directional ceiling vents
Bathroom power vent (select models)
Bath skylight (select models)
Carefree Travel'r 12V electric awning
Microwave oven with carousel
Multi-Media Premium Sound System
AM/FM/CD/DVD stereo with MP3 input jack
Outside shower (select models)
Oversized 21" oven (select models)
Quilted bedspread (select models)
Sink covers (2) (select models)
Tub surround
Water heater bypass (select models)

### DELUXE PACKAGE (SELECT MODELS)

8 cu. ft. Norcold refrigerator
16" aluminum rims
Solid-surface kitchen countertops
Solid-surface sink covers (2)
Stonecast double-bowl kitchen sink



FOR A COMPLETE LIST OF STANDARDS AND OPTIONS, SCAN HERE WITH YOUR SMARTPHONE OR VISIT JAYCO.COM.

## SPECIFICATIONS

	FLOORPLAN	EXT. LENGTH	EXT. WIDTH	EXT. HEIGHT (WITH A/C)	EXT. HEIGHT (WITH OPT. BEDROOM A/C)	INT. HEIGHT	UNLOADED VEHICLE WEIGHT (LBS.)	DRY HITCH WEIGHT (LBS.)	GROSS VEHICLE WEIGHT RATING (LBS.)	CARGO CARRYING CAPACITY (LBS.)	FRESH WATER CAPACITY (GAL.) (WITH WATER HEATER)	GRAY WASTEWATER CAPACITY (GAL.)	TOILET/BLACK WASTEWATER CAPACITY (GAL.)
SUPER LITE TRAVEL TRAILER	257RBS	TBD	TBD	TBD	—	TBD	TBD	TBD	TBD	TBD	TBD	TBD	TBD
	266RKS	29' 10"	96"	138"	—	84"	6,560	920	8,400	1,840	82	65	32.5
	284BHS	TBD	TBD	TBD	—	TBD	TBD	TBD	TBD	TBD	TBD	TBD	TBD
	298RLDS	34' 0"	96"	138"	—	84"	7,430	1,070	9,250	1,820	82	32.5	32.5
	304BHS	33' 5"	96"	138"	—	84"	6,905	920	9,000	2,095	82	32.5	32.5
	308RETS	TBD	TBD	TBD	—	TBD	TBD	TBD	TBD	TBD	TBD	TBD	TBD
	314BDS	35' 7"	96"	138"	—	84"	7,785	1,005	9,750	2,050	82	32.5	32.5
	316RKDS	TBD	TBD	TBD	—	TBD	TBD	TBD	TBD	TBD	TBD	TBD	TBD
	324BTS	TBD	TBD	TBD	—	TBD	TBD	TBD	TBD	TBD	TBD	TBD	TBD
	328RLTS	TBD	TBD	TBD	—	TBD	TBD	TBD	TBD	TBD	TBD	TBD	TBD
SUPER LITE HT FIFTH WHEEL	23.5RBS	25' 8"	96"	144"	—	78"	5,875	1,055	9,950	4,075	48	65	32.5
	26.5RKS	29' 11"	96"	145"	—	78"	6,705	1,365	9,950	3,245	48	65	32.5
	26.5RLS	29' 7"	96"	147"	—	78"	6,695	1,375	9,950	3,255	48	65	32.5
	27.5BHS	31' 5"	96"	145"	—	78"	6,830	1,330	9,950	3,120	48	65	32.5
SUPER LITE FIFTH WHEEL	28.5RLS	30' 9"	96"	151"	—	77"	7,800	1,755	10,200	2,550	92	65	32.5
	29.5RKS	31' 9"	96"	150"	—	72"	8,000	1,710	10,700	2,835	92	65	32.5
	30.5BHLT	34' 9"	96"	153"	153"	72"	9,205	1,820	11,700	2,565	92	65	32.5
	30.5RLS	33' 2"	96"	152"	—	72"	8,285	1,875	11,200	3,030	86	65	32.5
	31.5FBHS	34' 1"	96"	152"	—	67"	8,605	1,700	11,200	2,755	86	65	32.5
	31.5RLDS	34' 2"	96"	156"	156"	72"	8,905	2,185	11,700	2,975	82	65	32.5
	31.5RLTS	33' 10"	96"	157"	157"	72"	9,280	2,170	11,900	2,770	82	65	32.5
	33.5QBDS	TBD	96"	TBD	TBD	TBD	TBD	TBD	TBD	TBD	82	65	32.5

## INTERIOR DÉCOR CHOICES

### AMBER



### BROWNSTONE



### EMERALD



### COCOA



### WOOD





# JAYCO CONSTRUCTION

At Jayco, we've built a reputation for superior construction and craftsmanship. We always use top-quality materials and innovative manufacturing techniques—down to the smallest detail. The result? Unmatched resale value and peace of mind in an RV that's built to handle whatever the road throws at it, while outlasting everything but your memories.



All Jayco products are green certified. Eagle received a gold rating through use of sustainable materials, environmentally friendly production methods and reduction of waste.



## OLD WORLD CRAFTSMANSHIP

Jayco's dedicated production team includes Amish craftsmen who build with well-honed woodworking techniques passed down for generations.

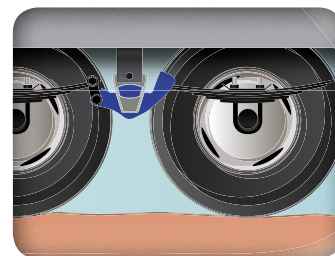

## INDEPENDENT SUSPENSION

Replacing typical steel equalizers, Eagle's MOR/ryde suspension system uses rubber springs to reduce vibration and isolate road shock, helping reduce wear-and-tear (n/a HT).



## WALL CONSTRUCTION

- 1 Vacuum-bonded sidewalls, slideouts and back wall:** Involves 15-18 minutes of 144 tons of pressure to ensure a stronger bond
- 2 Smooth fiberglass exterior:** Withstands use and travel—and Mother Nature, too
- 3 Welded aluminum frames:** Lighter than wood, increases Eagle Super Lite's towability

## FLOOR CONSTRUCTION

- 4 A solid foundation:** Laminated with welded tubular aluminum frame and 3/8" Weyerhaeuser decking with a total R-value of 10 (HT)
- 5 Durable construction:** 5/8" tongue and groove plywood with 2" x 3" floor joists on 16" centers with a total R-value of 10 (SL TT and SL FW)
- 6 Enclosed and heated underbelly:** Increases unit's aerodynamics while protecting undercarriage

## ROOF CONSTRUCTION

- 7 Seamless rubber roof:** Features one-piece construction, ensuring better leak protection
- 8 Fully walkable with 3/8" decking:** Provides full support against the elements
- 9 Standard reflective foil insulation:** Maintains interior temperatures for a total R-value of 22 (n/a HT)

## FEATURES

- 10 Dexter Nev-R-Adjust brakes:** Adjusts continuously in forward motion, getting half the stopping distance compared to other brakes
- 11 WaterWorks system:** Boasts at least 76 gallons of fresh water and Pex water lines, built to weather the elements (n/a HT)



# NOBODY OFFERS A BETTER WARRANTY THAN WE DO

## YOU WANT YOUR RV TO LAST A LONG TIME.

That's why we offer our exclusive 2-year Co-Pilot Warranty, the most comprehensive warranty program in the industry. Every Jayco RV undergoes rigorous quality control testing before it leaves the factory, so you can be confident your new Jayco will continue to provide the ultimate in liveability and reliability for years to come.

For a copy of our 2-year limited warranty with full terms and conditions, ask your local Jayco dealer.

## ROADSIDE ASSISTANCE

Travel worry-free with Jayco's Customer First Roadside Assistance program, yours at no cost during your first year of ownership. This program is offered through National Motor Club, the largest RV emergency road service in the country, and gives you immediate access to dependable roadside assistance and support services with a simple phone call.



TO LEARN MORE ABOUT  
OUR QUALITY CONTROL  
TESTING, SCAN HERE WITH  
YOUR SMARTPHONE.



## TRUE VALUE OF OWNERSHIP



### MORE STANDARD FEATURES

We pack more standard features into our RVs than anyone else. Even better, they're features we know you'll want, designed to make your RV more home-like, comfortable and convenient. Because at Jayco, it's always been about liveability.



### BRAND-NAME COMPONENTS

We like living up to the name we've built for ourselves. That's why we only use dependable components in our RVs, made by companies that value their reputation as much as we do ours.



### LESS MAINTENANCE

Our top-quality materials and production techniques let you spend more time enjoying your new RV and less time maintaining it.



### BETTER AVERAGE RESALE VALUE

In the last three years, Jayco owners have been banking on their investments. According to the NADA, Jayco's average resale value was 4.81% higher than the competition, giving Jayco the top resale value in the RV industry.



With Jayco, you get more amenities, more liveable, home-like features and superior construction for less maintenance and greater resale value. **Simply put, you won't find another RV packed with more TRUE VALUE.**



### VALUABLE AMENITIES

With standard features, like **A** | a surplus of storage—inside and out—**B** | Amish-crafted hardwood cabinetry and **C** | the Eagle Super Lite HT's grey-colored fiberglass exterior, you'll load up on True Value with Jayco.

### ENTERTAINMENT AND ESSENTIALS

Eagle Super Lite offers up top-notch features, like **A** | an indoor 26" or 32" LCD HDTV with 180-degree viewing angle, **B** | a magnet-friendly, residential-style Norcold refrigerator and **C** | an easy push-button Carefree awning.



### PUTTING THE FOCUS ON CAMPING

At Jayco, we don't want you fretting over your RV—today or years from now. So first, we make sure your RV is easy to use with amenities, like the Eagle Super Lite's all-new **A** | black tank flush. Then, we make sure your Jayco will stay in top shape by using only the highest-quality materials, like **B** | durable pre-drilled and screwed cabinet construction.



### HOLDING ITS VALUE

Years down the road, the Eagle will still be a RVer's dream. Complete with **A** | full-extension ball bearing drawer guides, **B** | an impressive 90-degree turning radius with our optional Reese Revolution pin box (select truck bed lengths) and **C** | an optional outside kitchen (select models), Eagle Super Lite is packed with amenities that make it appealing years from now.



# A TRADITION OF LIVEABILITY

**THE JAYCO STORY BEGAN IN 1968** when Jayco founder Lloyd Bontrager created an innovative, easy-to-use lifter system that led to a better fold-down camper. Loaded with more comforts and conveniences, Lloyd believed his camper would bring people closer together because it was more liveable. A devoted family man, Lloyd's passion extended to his business as well. In fact, our company's success stems from his insistence on treating everyone at Jayco as family — from our factory to our front office, our salespeople to our suppliers, and our customers to our community.

**BLENDING OLD WORLD AMISH CRAFTSMANSHIP WITH INNOVATIVE TECHNOLOGY**, Jayco is the nation's largest family-owned and operated RV manufacturer today. And while our product line has grown considerably over the years, every unit we build is still guided by Lloyd's vision and a humble desire to help make it easier for families to explore together and relax together. It's what separates us from other RV manufacturers. And it's what continues to make Jayco America's Most Liveable RVs.



AMERICA'S MOST **LIVEABLE** RVs.

Colton RV  
North Tonawanda, NY 14120  
(716) 694-0188  
(800) 628-4889  
[www.ColtonRV.com](http://www.ColtonRV.com)



Jayco proudly sponsors Tread Lightly!, a nonprofit organization whose mission is to empower generations to enjoy the outdoors responsibly through education and restoration.

**Unloaded Vehicle Weight (UVW):** Sometimes referred to as "Dry Weight," UVW means the typical weight of this trailer as built at the factory. The UVW, as used in product literature and other promotional materials, does not include cargo, fresh water, propane, options or dealer-installed accessories.

**Gross Vehicle Weight Rating (GVWR):** GVWR means the maximum permissible weight of the trailer, including the UVW plus passengers, personal items, all cargo, fluids, options, and dealer-installed accessories. The GVWR is equal to or greater than the sum of the UVW and the CCC.



From RV insurance to extended warranties, JayPlus has it covered. Ask your Jayco dealer about our exclusive JayPlus program today.

**Cargo Carrying Capacity (CCC):** CCC means the maximum weight of all passengers, personal items, food, fresh water, propane, tools, other cargo and dealer-installed accessories that can be carried by the trailer. CCC is equal to or less than GVWR minus UVW. The addition of options will decrease the CCC.

**Hitch Weight (HW):** The hitch weight, as used in product literature and other promotional materials, does not include cargo, fresh water, propane gas, options or dealer-installed accessories. The addition of these types of items will either add to or subtract from the stated hitch weight.



As a Jayco owner, you can be part of the Jayco Jafari International Travel Club. Ask your dealer about the Jafari "flight" in your area, write Jayco or visit our website.

It is important for your safety and enjoyment that your tow vehicle be adequately sized and equipped to tow and handle the GVWR of the RV you select. Review weights and rating of your tow vehicle and consult a competent advisor for questions or advice. Whether you are new to RVing or a veteran, get a feel for the performance of your tow vehicle before heading out on the roadways. When you tow an RV, you must drive differently than when you drive a single vehicle. Practice hooking up, driving, backing up and braking in a safe environment or seek out professional instruction. Jayco affixes a weight label to each RV which lists weight information for that vehicle. See specifications chart inside.

**Jayco, Inc., P.O. Box 460, Middlebury, IN 46540, [www.jayco.com](http://www.jayco.com) **

See dealer for further information and prices. All information in this brochure is the latest available at the time of publication approval. Jayco reserves the right to make changes and to discontinue models without notice or obligation. Photos in this brochure may show optional equipment and props for photography purposes. RVs built for sale in Canada may differ to conform to Canadian codes. ©2011 Jayco, Inc. 12-EGSL-PL 1111-50K Printed in U.S.A.